



Model Number

921LC2

Features

- Basic series
- 2 mm flush

Technical Data

General specifications

Switching element function		NAMUR, NC
Rated operating distance	s_n	2 mm
Installation		flush
Assured operating distance	s_a	0 ... 1.62 mm

Nominal ratings

Nominal voltage	U_o	8.2 V
Operating voltage	U_B	5 ... 15 V
Switching frequency	f	0 ... 1000 Hz
Current consumption		
Measuring plate not detected		≥ 2.7 mA
Measuring plate detected		≤ 1.8 mA

Ambient conditions

Ambient temperature	-10 ... 65 °C (14 ... 149 °F)
---------------------	-------------------------------

Mechanical specifications

Connection type	Solder connection
Housing material	PA
Sensing face	PA
Degree of protection	IP67

Compliance with standards and directives

Standard conformity	
NAMUR	EN 60947-5-6:2000
Standards	EN 60947-5-2:2007 IEC 60947-5-2:2007

Approvals and certificates

CCC approval	CCC approval / marking not required for products rated ≤ 36 V
--------------	--

Dimensions

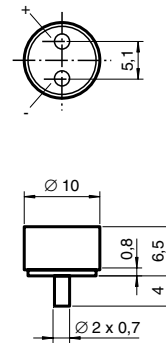

Electrical Connection

